

12TH STREET FORCEMAIN IMPROVEMENTS

PROJECT #13-011-001
VILLAGE OF WELLSVILLE
COLUMBIANA COUNTY, OHIO
AUGUST 2013

SHEET INDEX

| | |
|----------------|-----|
| TITLE SHEET | 1 |
| GENERAL NOTES | 2 |
| PLAN & PROFILE | 3-5 |

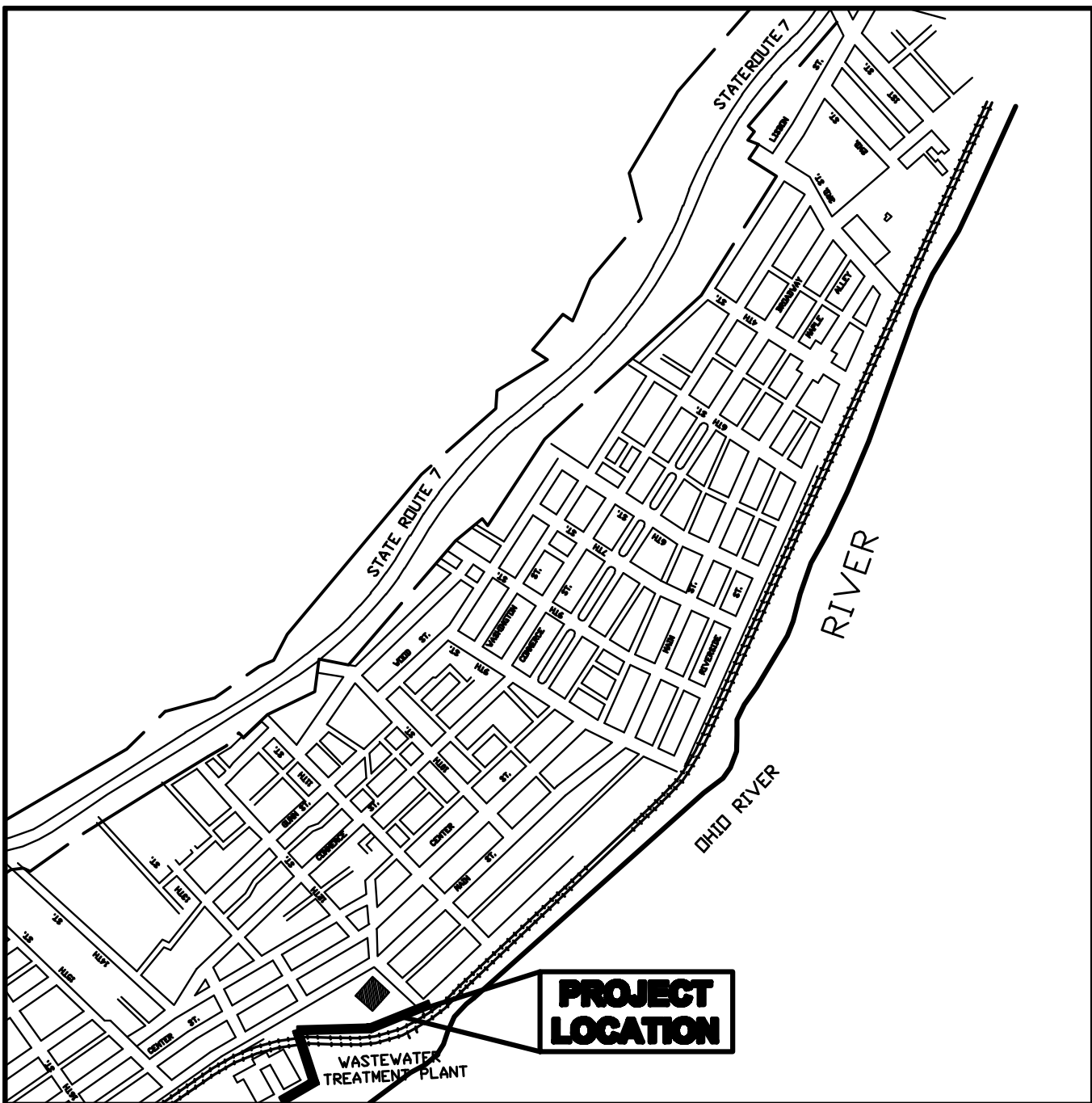

LOCATION MAP

APPROVALS

MAYOR:

SUSAN A. HAUGH
DATE _____

THOMAS EDGELL VILLAGE ADMINISTRATOR
ANDREW BEECH VILLAGE ATTORNEY
CASSANDRA BLOOR FISCAL OFFICER

VILLAGE COUNCIL

DON BROWN COUNCIL PRESIDENT PRO TEM
ROSIE GOSS VILLAGE COUNCIL
TONY CATALDO VILLAGE COUNCIL
DIANE DINCH VILLAGE COUNCIL
JOHN MORROW VILLAGE COUNCIL
TONDA ROSS VILLAGE COUNCIL

UNDERGROUND UTILITIES

CONTACT BOTH SERVICES
CALL TWO WORKING DAYS
BEFORE YOU DIG

CALL
1-800-362-2764
(TOLL FREE)
OHIO UTILITIES PROTECTION SERVICE
NON-MEMBERS
MUST BE CALLED DIRECTLY

OIL & GAS PRODUCERS PROTECTIVE
SERVICE CALL: **1-800-925-0988**

JOHN M. SABO, PE# E-69811
DATE _____

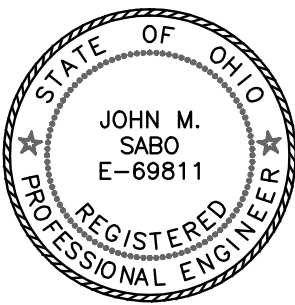

CALCULATED
T.M./J.S.

DATE

CHECKED
J.S./N.W.

DESCRIPTION

REV. NO.

12TH STREET FORCEMAIN IMPROVEMENTS

VILLAGE OF WELLSVILLE

1

5

BASE BID NOTE:

BASE BID: RECONNECT 12" HDPE F.M. TO EX. 12" F.M. AT STA. 14+32

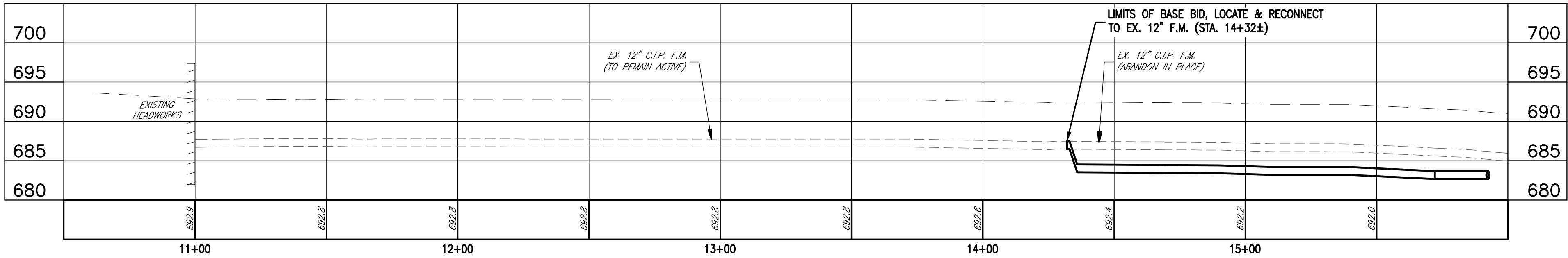
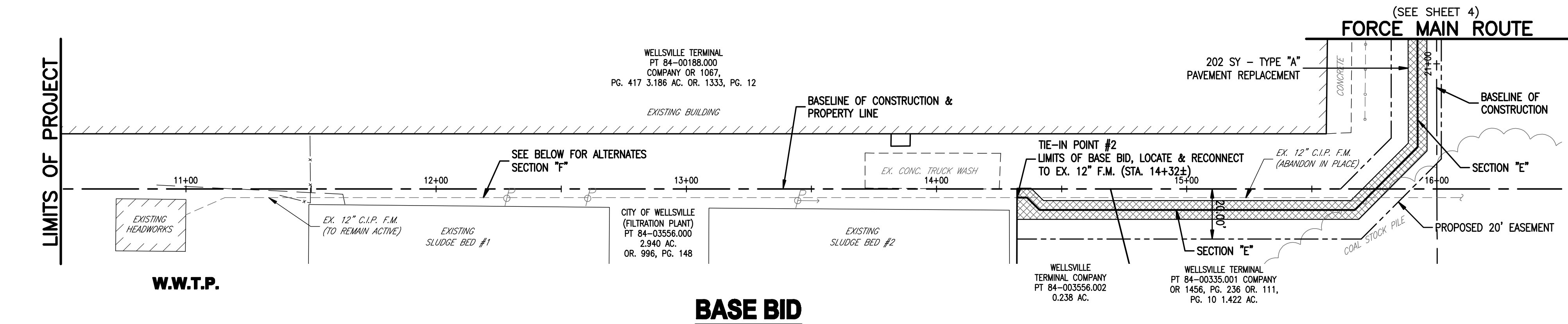

ALTERNATE NOTES FOR SECTION "F":

ALTERNATE BID #1: HORIZONTAL DIRECTIONAL DRILL NEW 12" HDPE F.M. FROM STA. 14+32 TO STA. 11+00 (EX. HEADWORKS BUILDING)

ALTERNATE BID #2: PIPE BURST EX. 12" C.I.P. F.M. FROM STA. 14+32 TO STA. 11+00 (EX. HEADWORKS BUILDING)

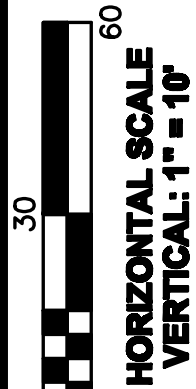
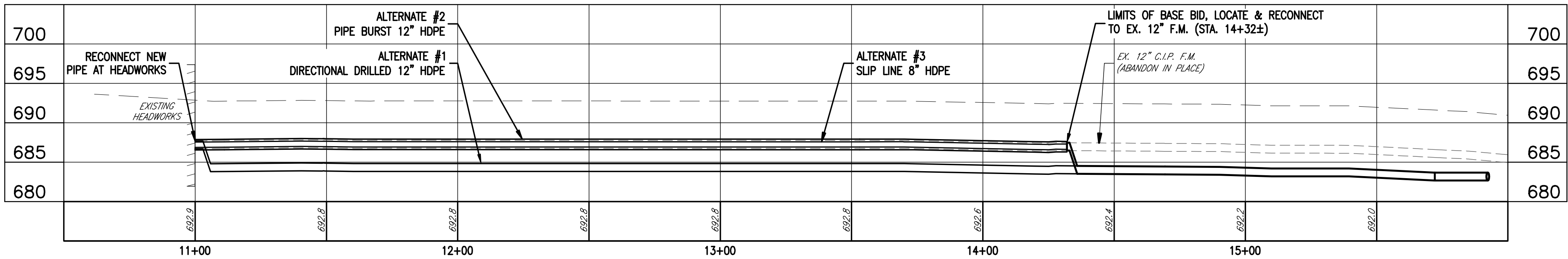
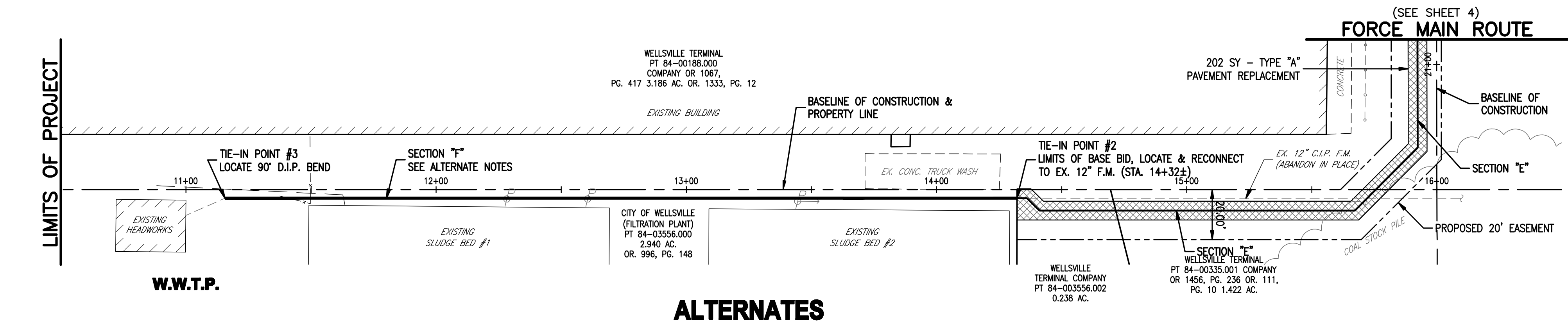

| DATE | REV. NO. | CHECKED | CALCULATED |
|------|----------|---------|------------|
| | | | |





A cross-sectional diagram of a carrier pipe assembly. The central component is a 'CARRIER PIPE'. It is surrounded by a 'STEEL CASING'. 'STAINLESS STEEL STRAPPING' is shown as a series of horizontal bands around the carrier pipe. The entire assembly is supported by a 'MINIMUM OF (FOUR) 4" WOLMANIZED WOOD SKID OR MANUFACTURED SKIDS Banded TO CARRIER PIPE EQUALLY SPACED.' The top of the carrier pipe is filled with 'SAND OR GROUT FILL AS REQUIRED'.

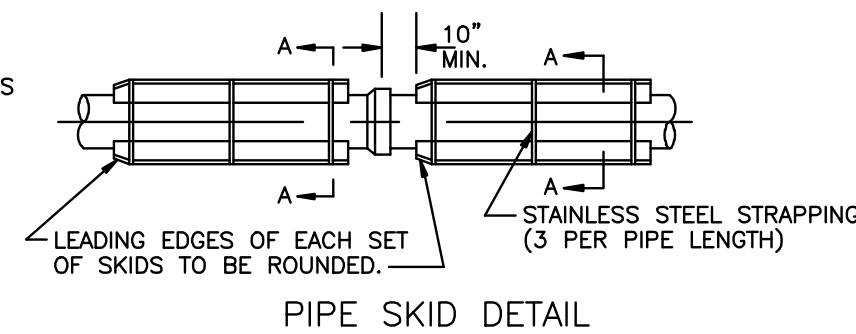
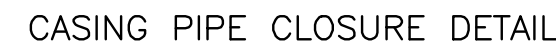

BORING DETAIL
NOT TO SCALE

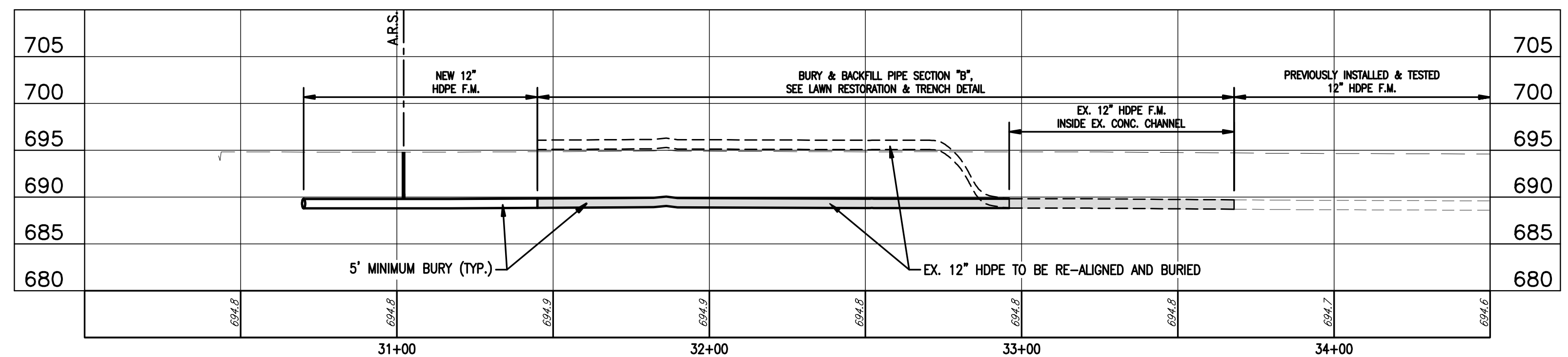
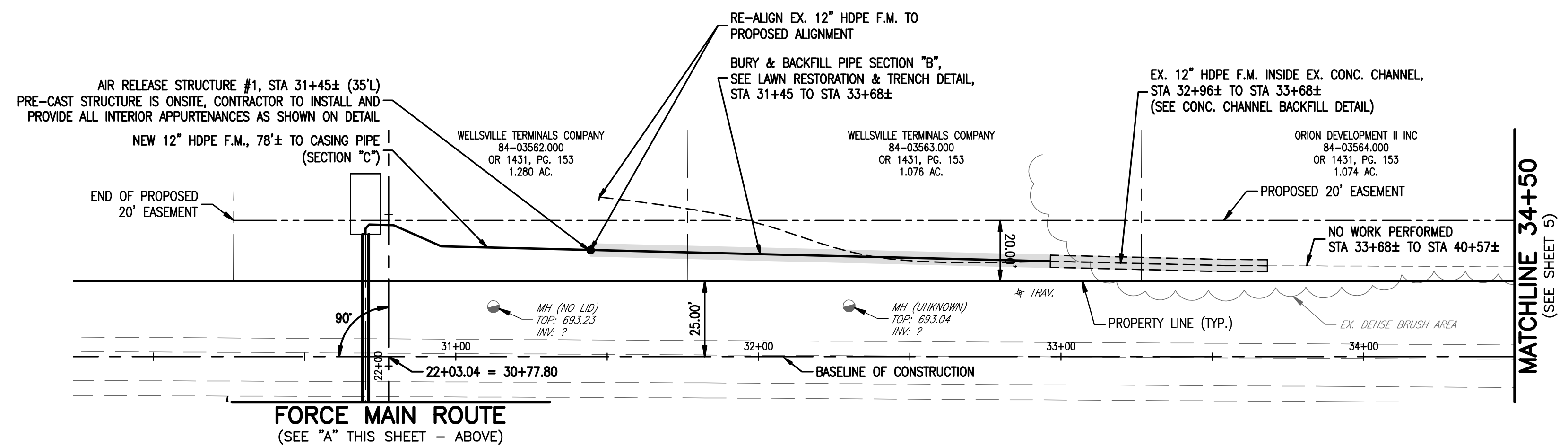
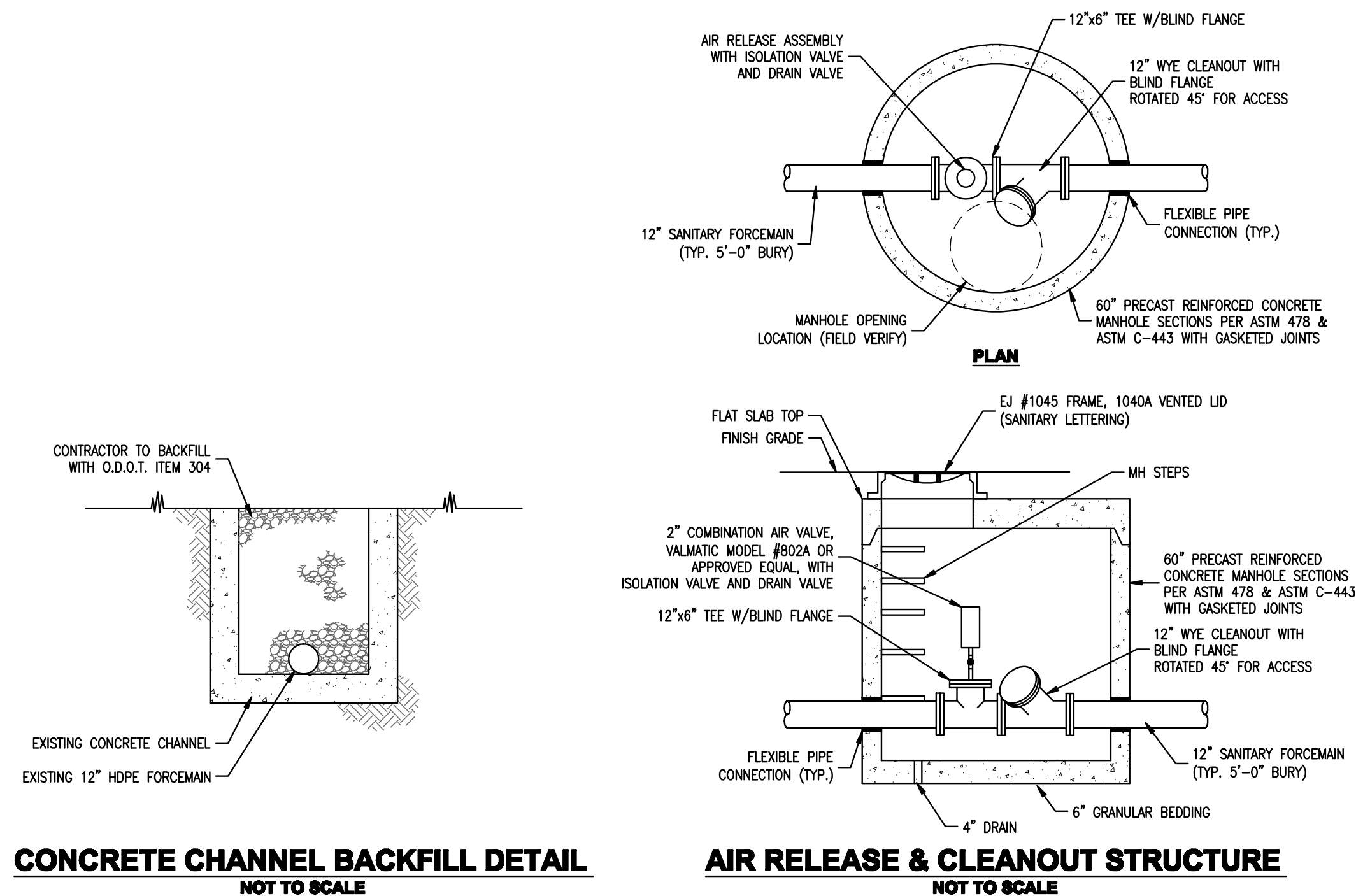
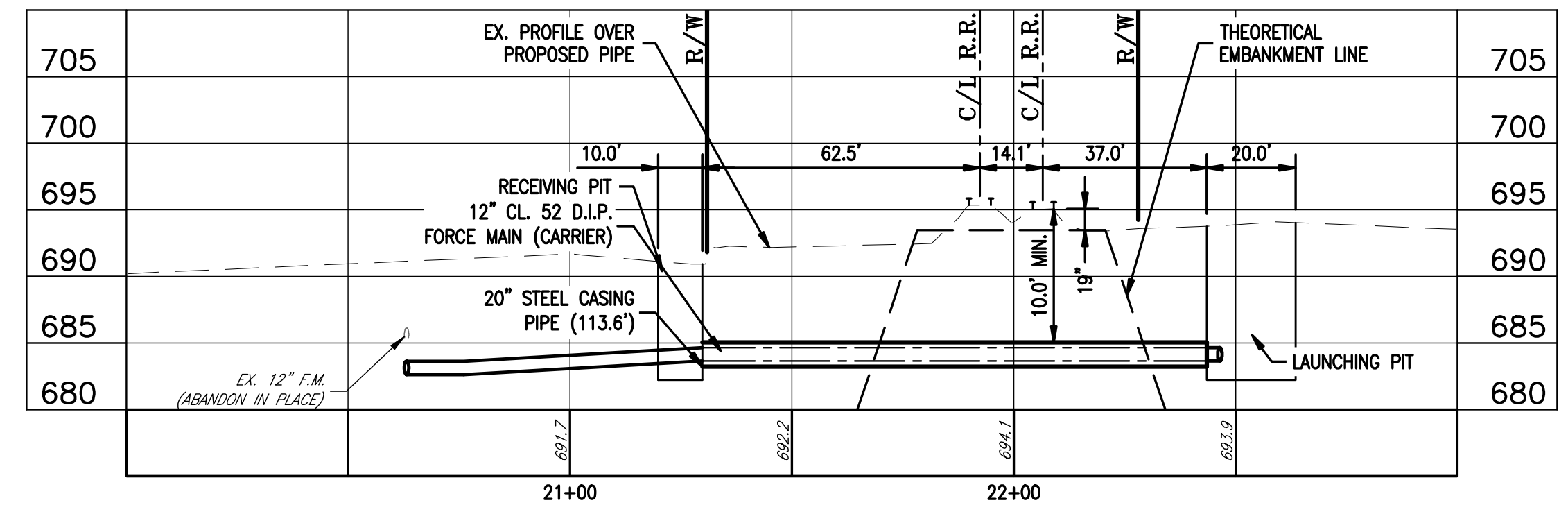
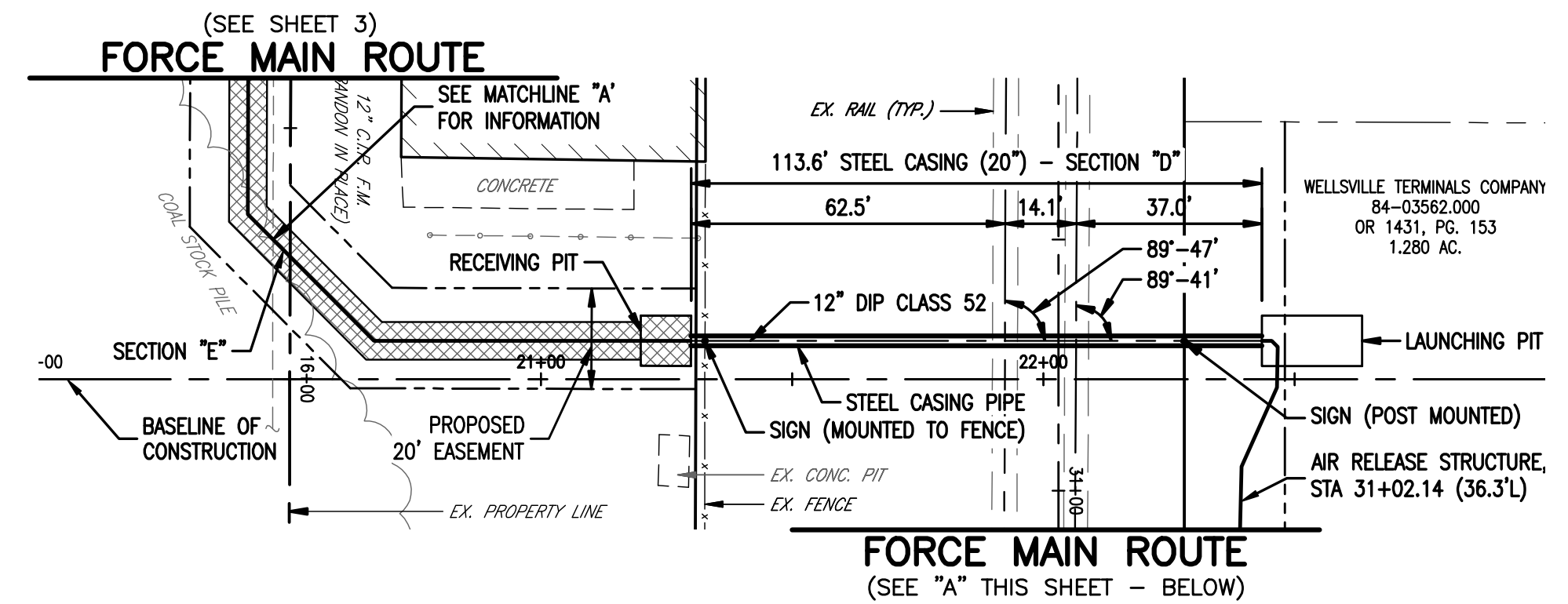

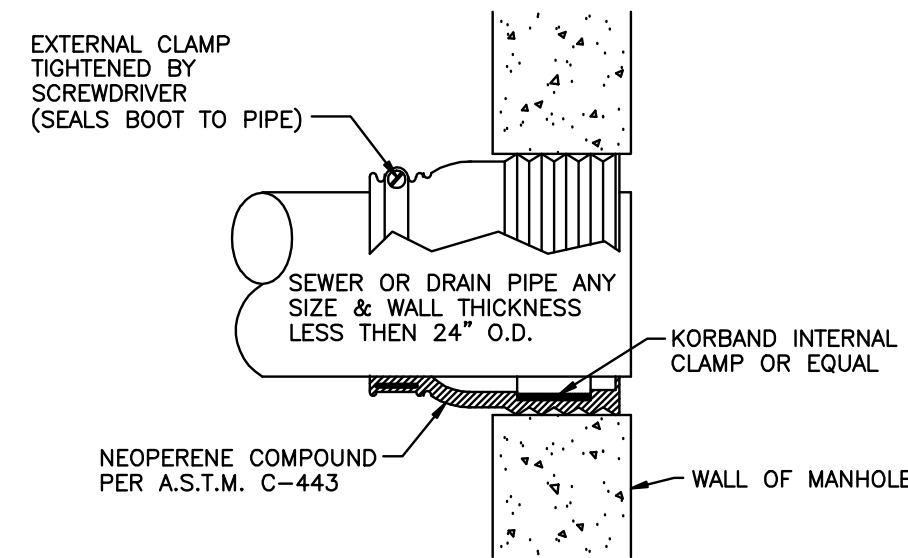
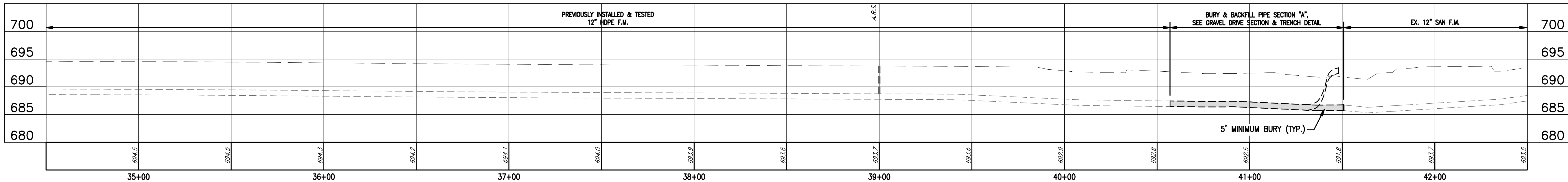
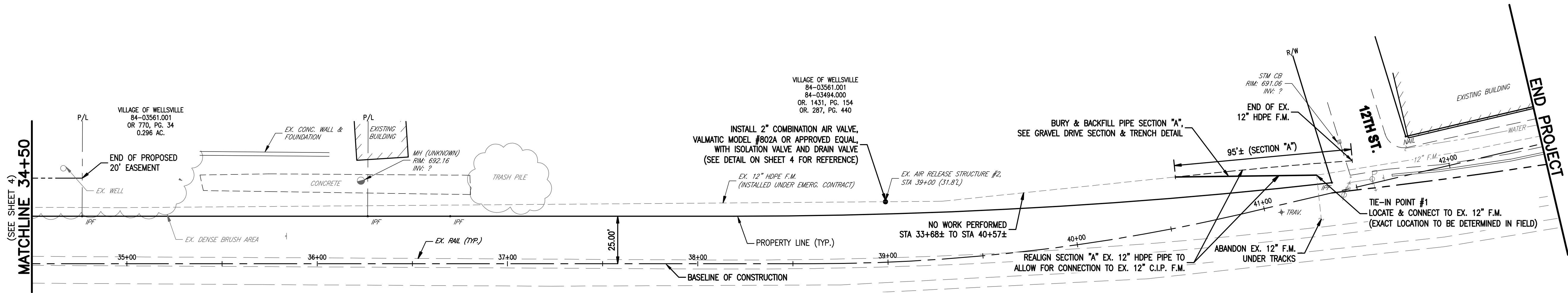

FLEXIBLE GASKET DETAIL
NOT TO SCALE

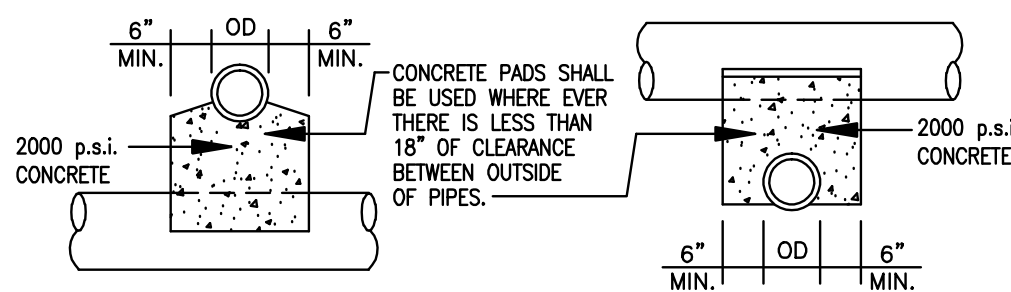

PIPE CROSSING DETAIL
NOT TO SCALE

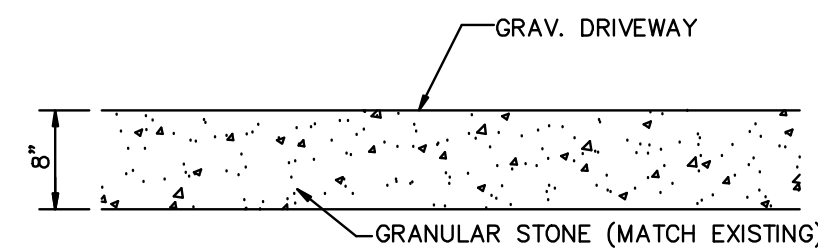

GRAV. DRIVE SECTION
NOT TO SCALE

*NOTE: TRACER WIRE & METALLIC TRACER TAPE
THE ENTIRE LENGTH OF FORCE MAIN INSTALLED ON THIS PROJECT SHALL BE PROVIDED WITH TRACER WIRE (THIN 12AWG SOLID COPPER GREEN) AND METALLIC TRACER TAPE (2\"/>

THE CONTRACTOR SHALL ALSO PROVIDE AND INSTALL SIX (6) RHINO TRIVIEW FLEX TRACING WIRE STATIONS OR APPROVED EQUAL. THE UNITS SHALL HAVE EXTERNAL TERMINALS. THE MARKERS SHALL BE GREEN IN COLOR AND DESIGNATE A SEWER FORCE MAIN. LABELS SHALL INCLUDE EMERGENCY PHONE NUMBER AND CONTACTS PER THE VILLAGE OF WELLSVILLE. INSTALLED LOCATIONS WILL BE FIELD DIRECTED ON THE 12\"/>

UNDER AND WITHIN 3' OF EXISTING OR PROPOSED PAVEMENT, ROADS, DRIVES, WALKS AND STRUCTURES. (SEE APPROPRIATE RESTORATION DETAIL).

*INSTALL CONTINUOUS METALLIC TRACER TAPE ABOVE FLEXIBLE PIPE.

LEGEND:
A—USE GRANULAR BEDDING MATERIAL TYP. (ASTM 2321, CLASS 1 OR AASHTO 56.57.68) OR OTHER APPROVED GRANULAR MATERIAL IN COMPACTED 6\"/>

| NOMINAL PIPE DIA. | MAX. TRENCH WIDTH AT TOP OF PIPE |
|-------------------|----------------------------------|
| THRU 24" | O.D. + 24" |
| OVER 24" THRU 66" | O.D. + 30" |
| 72" & LARGER | O.D. + 48" |

NO SLAG BEDDING SHALL BE USED WITH WATER LINES OR METAL CONDUIT OR WHERE NOTED.

TRENCH & BEDDING DETAILS
NOT TO SCALE

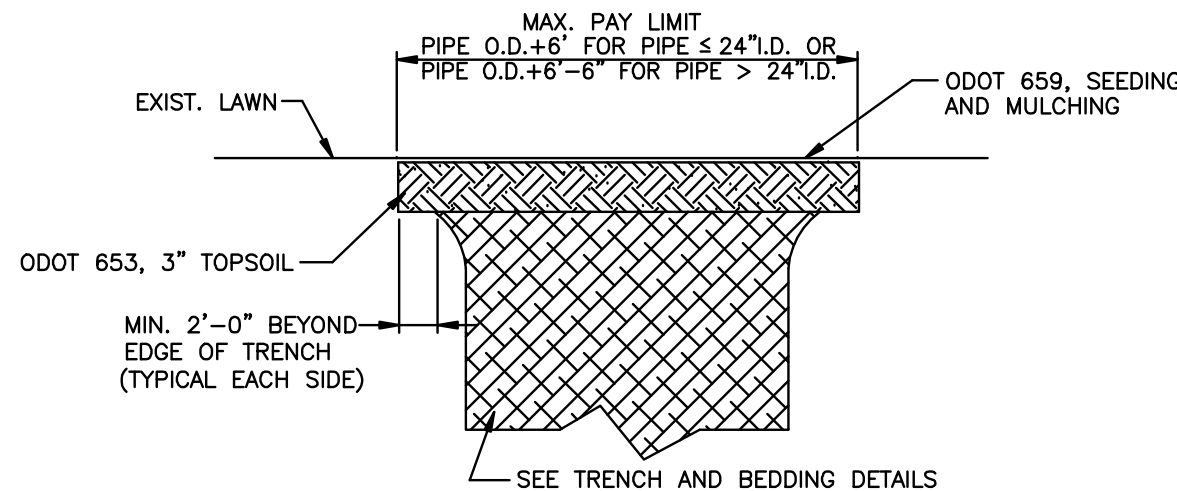

LAWN RESTORATION DETAIL
NOT TO SCALE

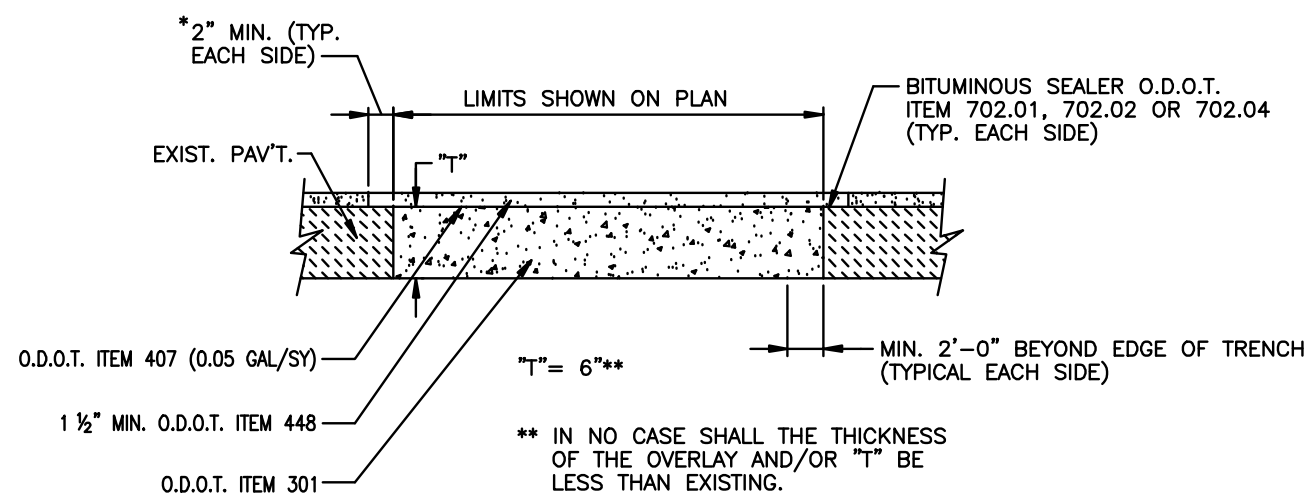

PAVEMENT REPAIR DETAIL
NOT TO SCALE